

Part NO. SS-RUI3540P405N	Type RFID Antenna
---------------------------------	-------------------

Electrical Characteristics

Antenna

1	Antenna model	35*35*4mm
2	Frequency Range	902MHz~928MHz
3	V.S.W.R	2.0 max
4	Band With@RL=-10dB	≥10MHz
5	Gain@Zenith	1.5dBi@40*40mm Ground
6	Impedance	50 Ω
7	Polarization	RHCP
8	Axial Ratio@Zenith	<3dB

Material

No	Part Name	Spec
1	Antenna	Dielectric Ceramics
2	Ground	0.8mm, FR-4
3	Cable	L=95mm, RG-178
4	Connector	MMCX-JW (Male90°)

Environment Condition

1	Working Temp	-40°C ~ +85°C, 10%~95% RH
2	Storage Temp	-45°C ~ +90°C, 10%~95% RH

Dimensions

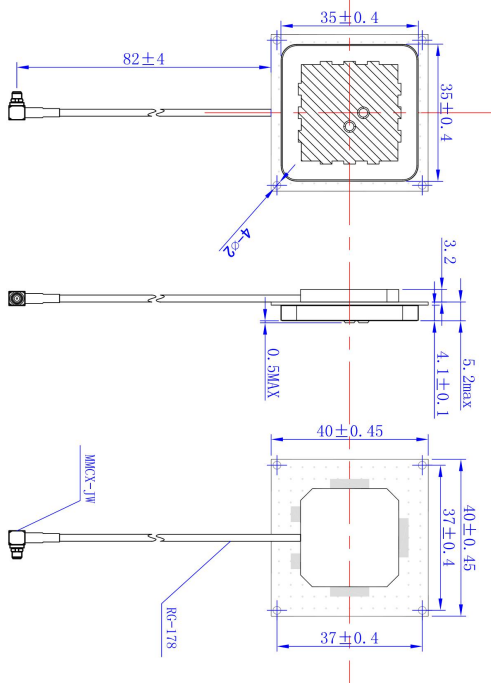

Return Loss & Impedance

